

CantiLever

short pull Lever

compatible with cantilever brakes & road caliper brakes including PAUL Racer, Touring & Neo-Retro brakes

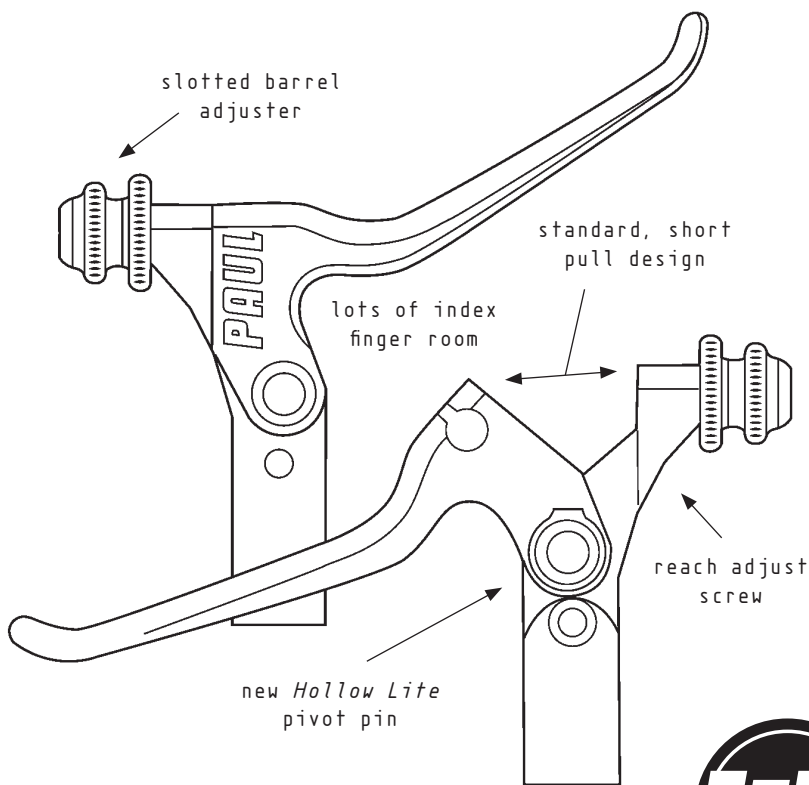

made in USA



Nice parts since 1989

INSTALLING *CantiLever*

PLEASE READ CAREFULLY

Periodically lube with a few drops of chain lube. DO NOT OVER-TIGHTEN HANDLEBAR CLAMP SCREWS. The lever should move on the handlebar when tugged on, this will prevent the lever from breaking in a crash. Warranty does not cover damage to levers that are over-tightened.

compatible with these PAUL brakes:

touring canti

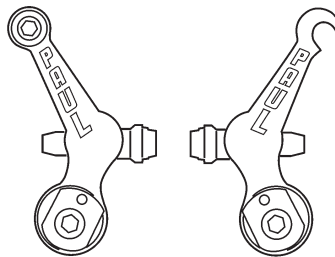

neo retro

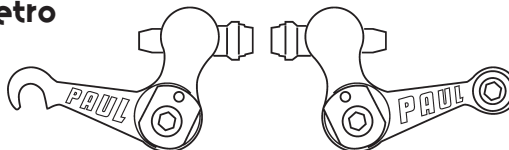

racer

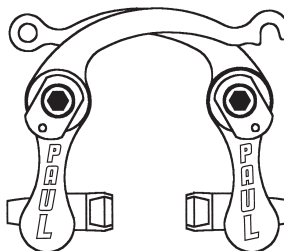

PAUL Component Engineering
www.paulcomp.com