

Replacement Brake Springs

Compatible with all PAUL brakes.

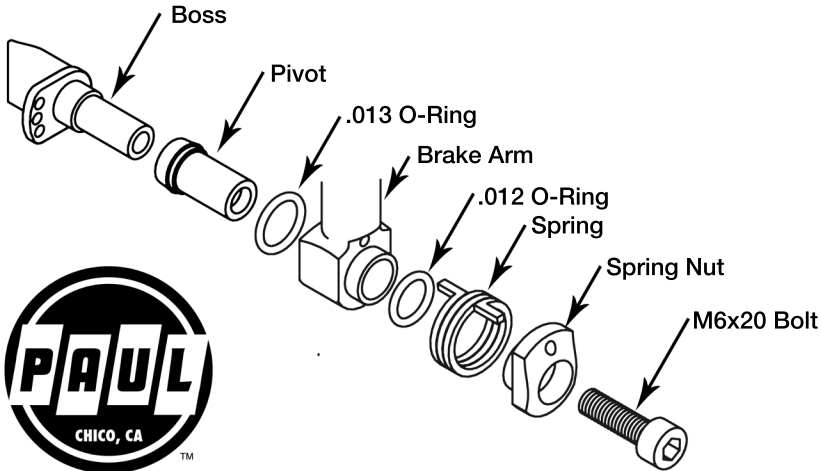

Brake springs are directional and must be mounted on the correct side of the brake. Double-check orientation before tensioning.

Neo-Retro, Touring Canti, MotoLite, MotoBMX:

Left: **Gold Spring**

Right: **Silver Spring**

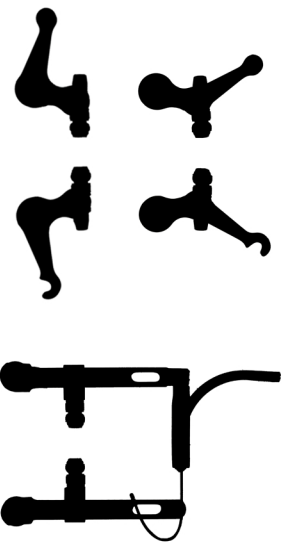

Racer and Racer Medium:

Left: **Silver Spring**

Right: **Gold Spring**

